



## Wemet Lift Machinery Co.,Ltd

### Add

No.9 Beicheng Industrial Park, Jiyang District, Jinan City, Shandong Province

### Tel

+86-531-88763831

### Fax

0531-84211872



website



# Villa Elevator





## Home Lift

Understand lift, understand you.

---

Customized,  
personalized design,  
Meet your various performance  
needs and uses,  
Give you an ideal life beyond  
imagination,  
Personalized exclusive service,  
Understand life better understand  
you.



# Elevator Customization Expert

“

Unlike the standardized service of traditional elevators, we pay more attention to the diversified needs of life, focusing on more advanced intelligence and safety technology, more sophisticated materials and configurations, breaking through the problems of traditional elevator shafts and structures, and taking professional Standard customized services provide exclusive elevator solutions for high-end people and middle-class families, making it the choice for improving the quality of modern home life.

Each subtle design is to let you enjoy life better, experience more elegant and smarter modern home quality, and give your family delicate and thoughtful care.

”

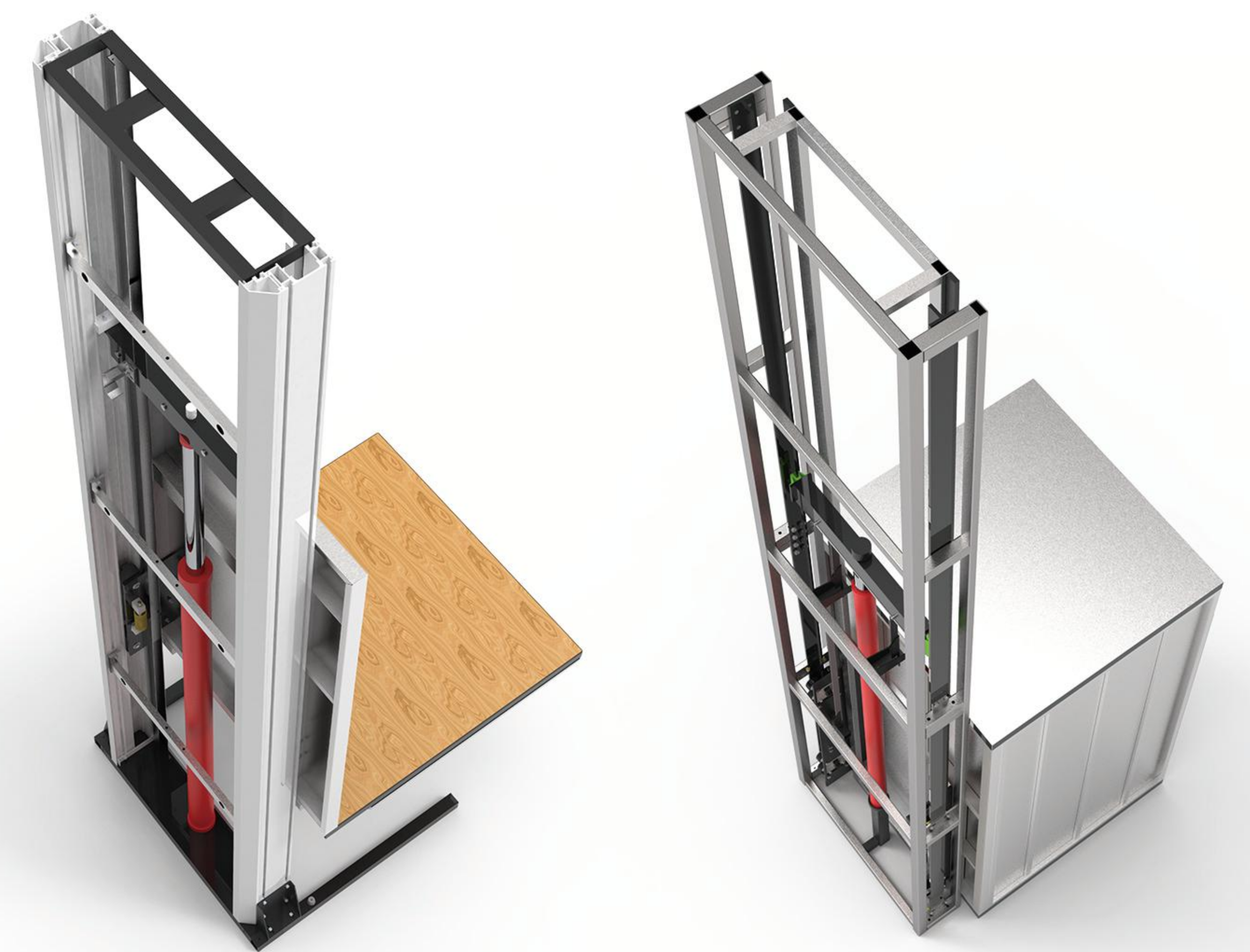



# Hydraulic Villa Elevator

Adopt advanced standardized track and universal accessories. Easy to assemble and maintenance. Advanced mute hydraulic station with no setback provides quiet and comfortable riding. The advanced frame structure requires no pit nor machine room, apply to any installation scene.

## Features:

- ◎ No machine room nor shaft is required: for any installation space
- ◎ Standardized track: easy for home users to assemble
- ◎ Anti-fall system: never fall
- ◎ Silent power station: energy saving, comfortable riding, quiet
- ◎ UPS : backup power

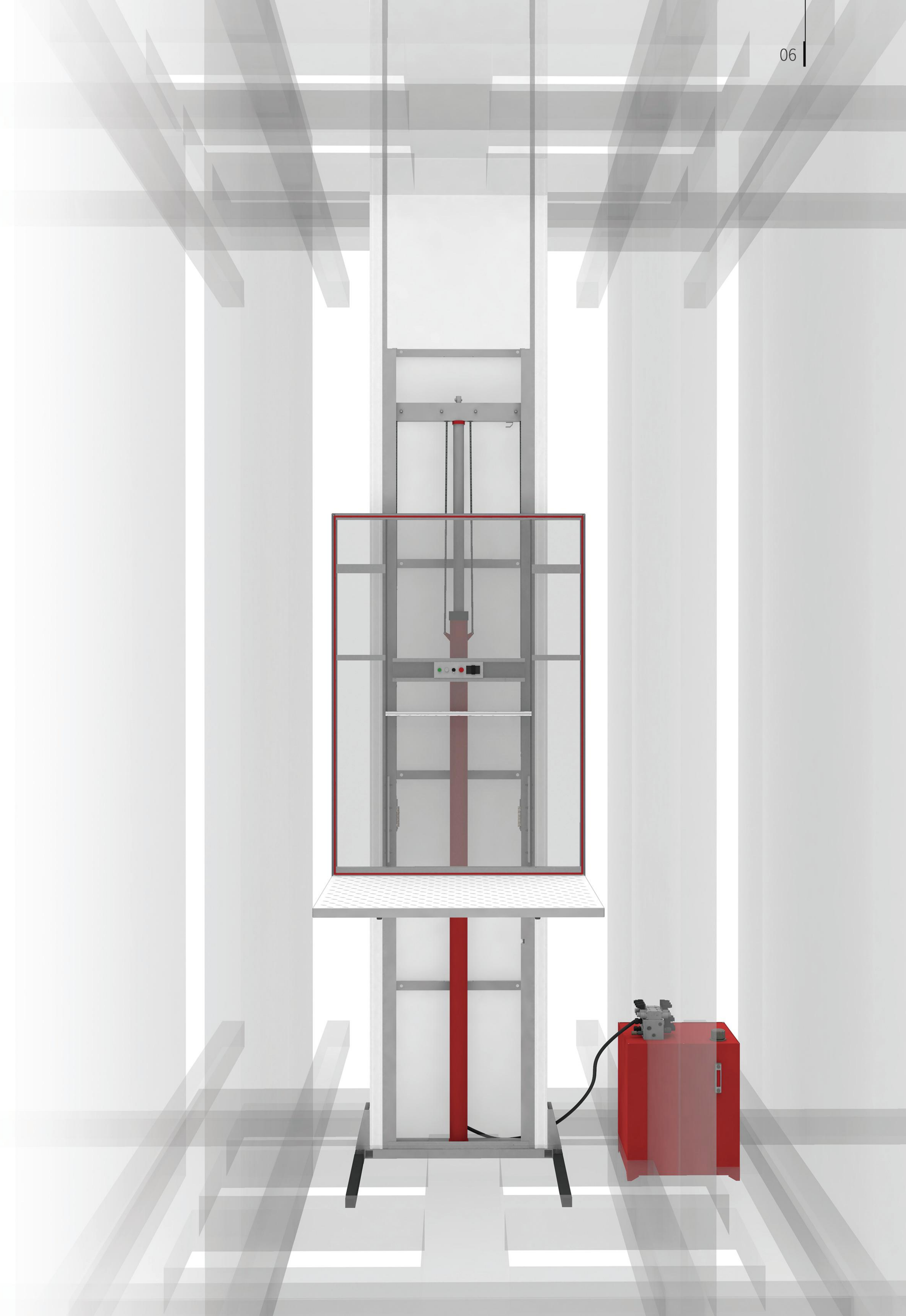



# Applicable occasions and humanized design

Each lift is special designed according to the building, Greatly improving the space utilization and harmony with the environment.

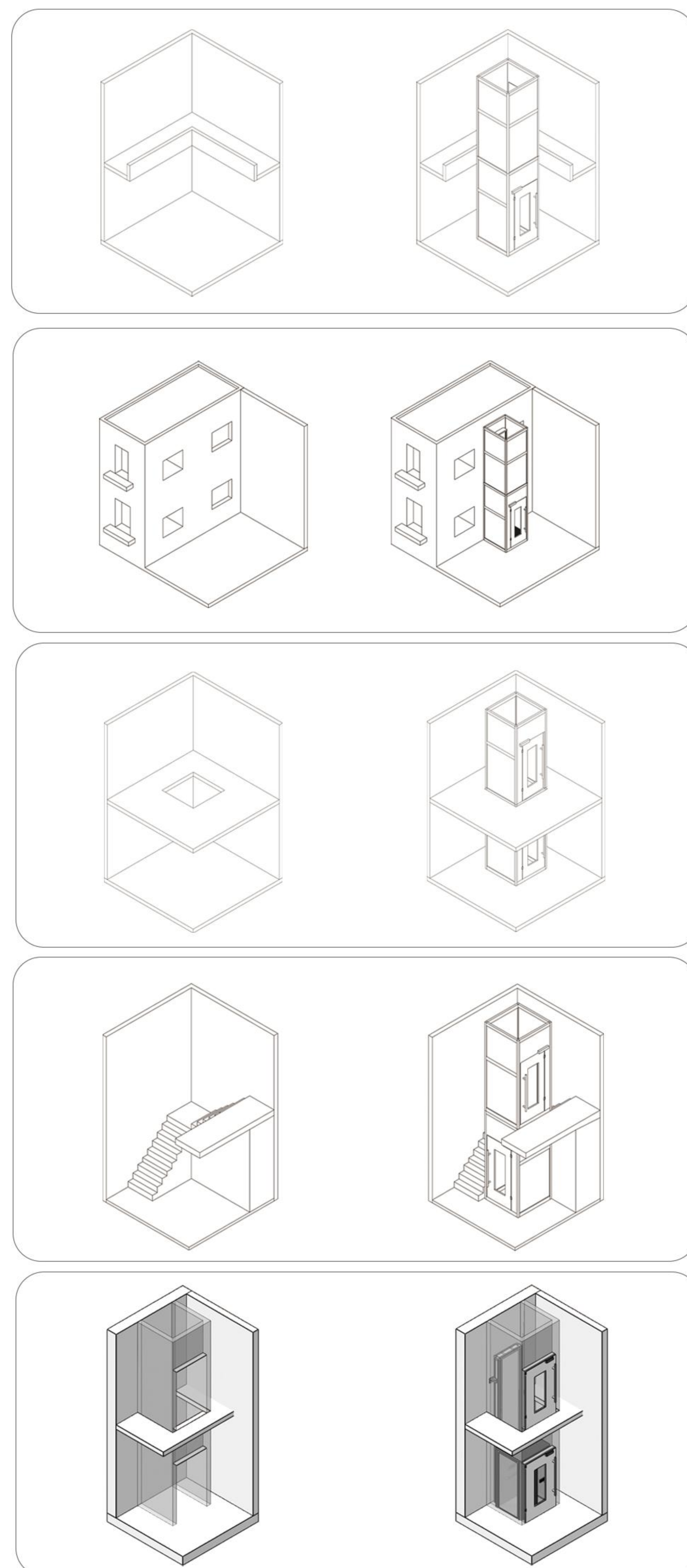

## Indoor installation

- Only a simple fixed point is needed;
- Apply to LOFT in high-rise buildings;
- Require no pit nor overhead height.
- If the base height is not enough, the half-height door is optional

## Outdoor installation

- The transformation is convenient and simple;
- Good-look, practical and money saving;
- Rain and corrosion protection;
- Suitable for villas and Loft without shafts;

## Installation at the floor opening

- Suitable for families without suitable space;
- Only need a opening in the floor about 1m<sup>2</sup>;
- Suitable for lofts together with renovation or small spaces;

## Staircase corner installation

- Space-saving design and good-look;
- Small space occupation and four-sided glass shaft;
- Sightseeing elevator in the middle of the spiral staircase;
- Can be installed on the ground or the same height of the floor;

## Installed in a shaft;

- Own well structure;
- Landing door options (Manual or automatic);
- Applicable to concrete brick walls;
- Customize colors that match the house renovation





# Decoration Configuration

## Control box series



Panel-001



Box-001



Box-002



Box-003



Box-004



Box-005



Box-006



Box-007



Box-008



Box-009



Box-010



Box-011

## Floor series

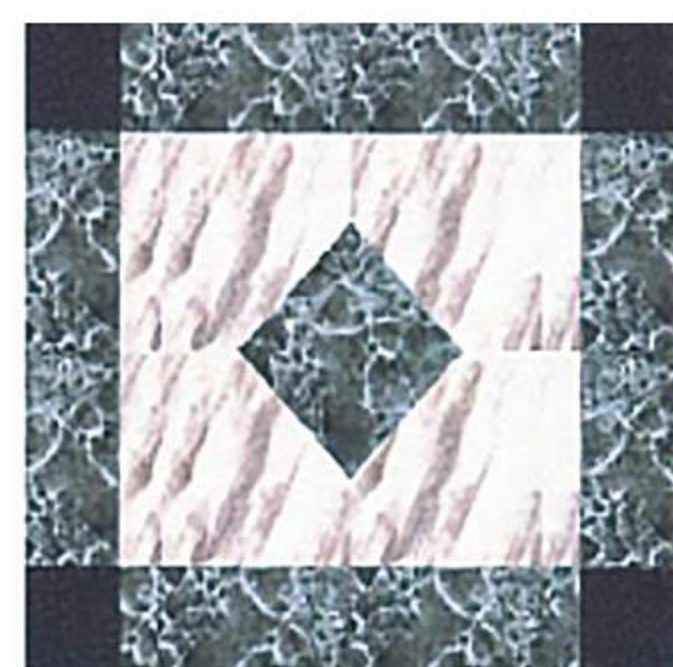

Floor-001



Floor-002



Floor-003

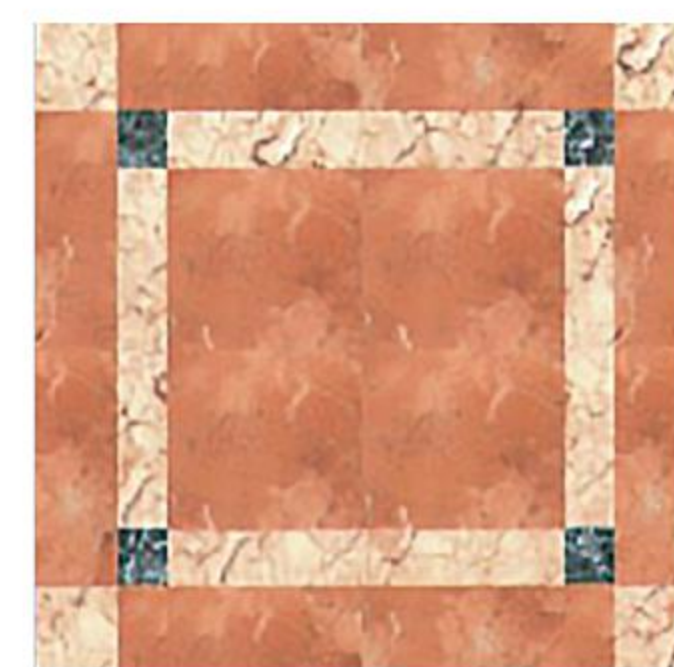

Floor-004

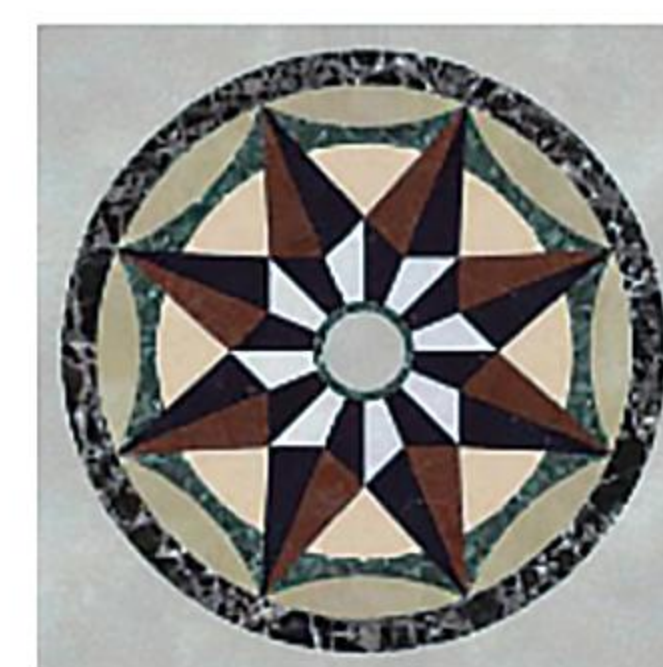

Floor-005

## Automatic door series



Door-001



Door-002

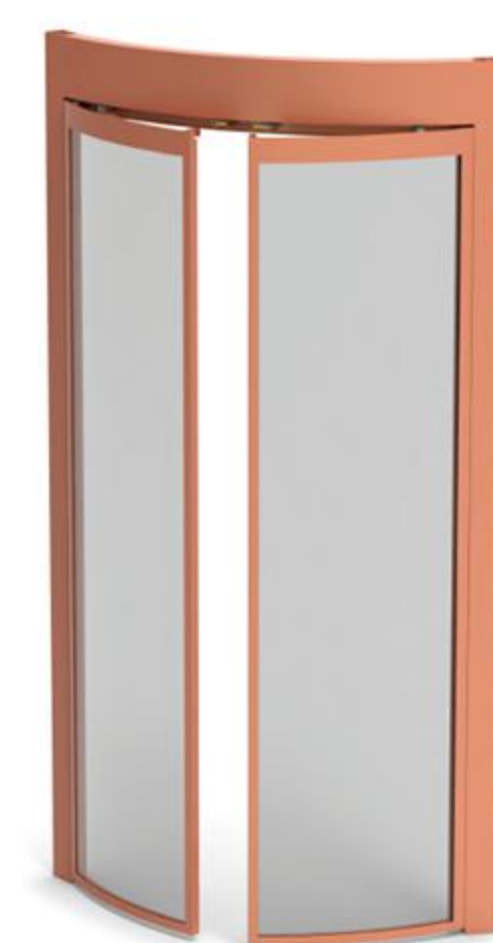

Door-003

## Door handle series

Material: aluminum  
magnesium alloy  
Model: L=250mmMaterial: aluminum  
magnesium alloy  
Model: L=220mmMaterial: aluminum  
magnesium alloy  
Model: L=220mmMaterial: aluminum  
magnesium alloy  
Model: L=220mmMaterial: aluminum  
magnesium alloy  
Model: L=220mmMaterial: crystal  
Model: L=300mmMaterial: Zinc alloy  
Model: L=410mmMaterial: aluminum  
magnesium alloy  
Model: L=320mmMaterial: Zinc alloy  
Model: L=320mmMaterial: jade  
Model: L=380mm

## Manual door series



white



champagne silver



champagne gold



Rose gold



Red wood grain



black



White Oak



creamy-white



## *Aluminum alloy shaft series*

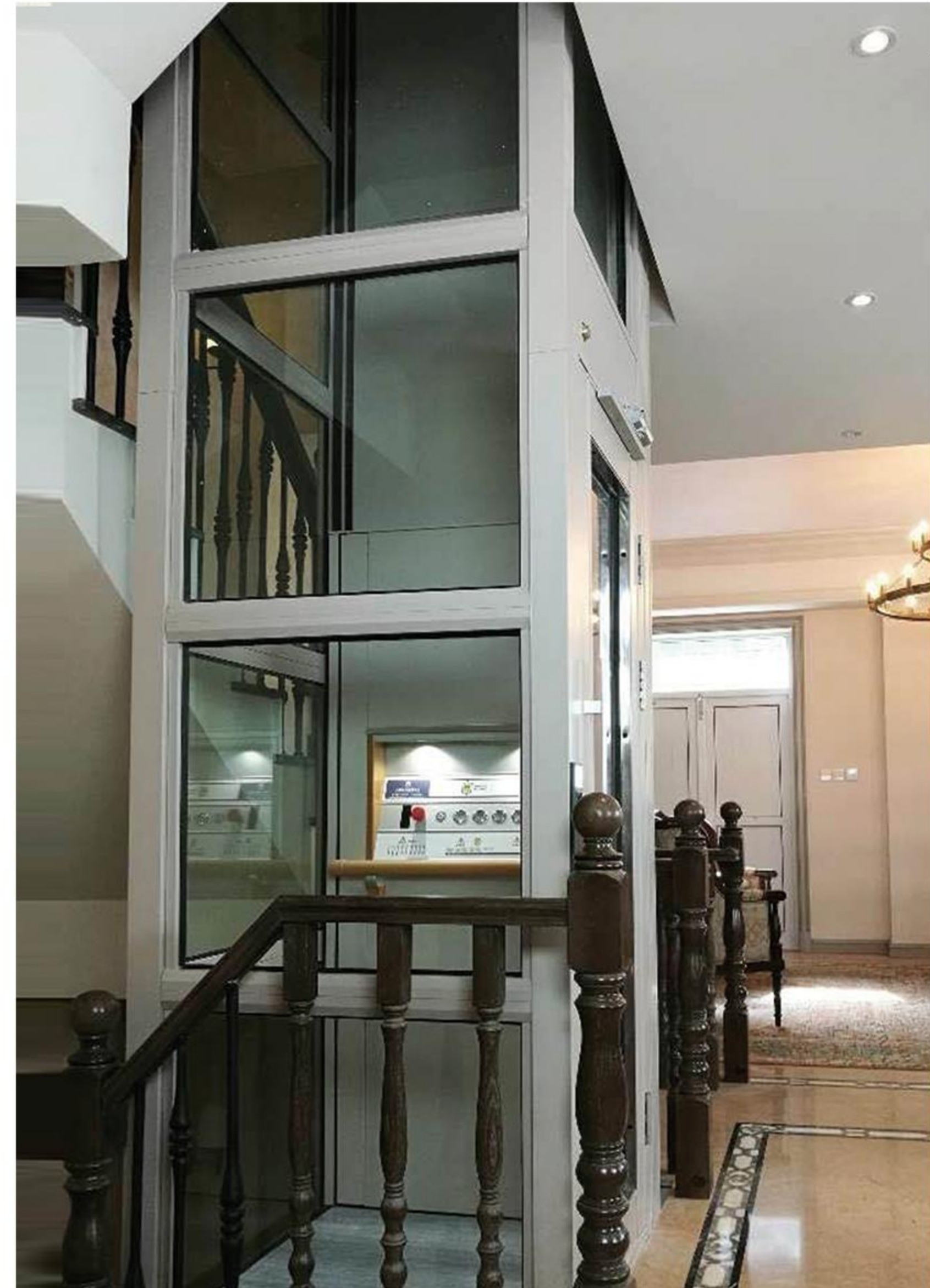



## Floor opening plan

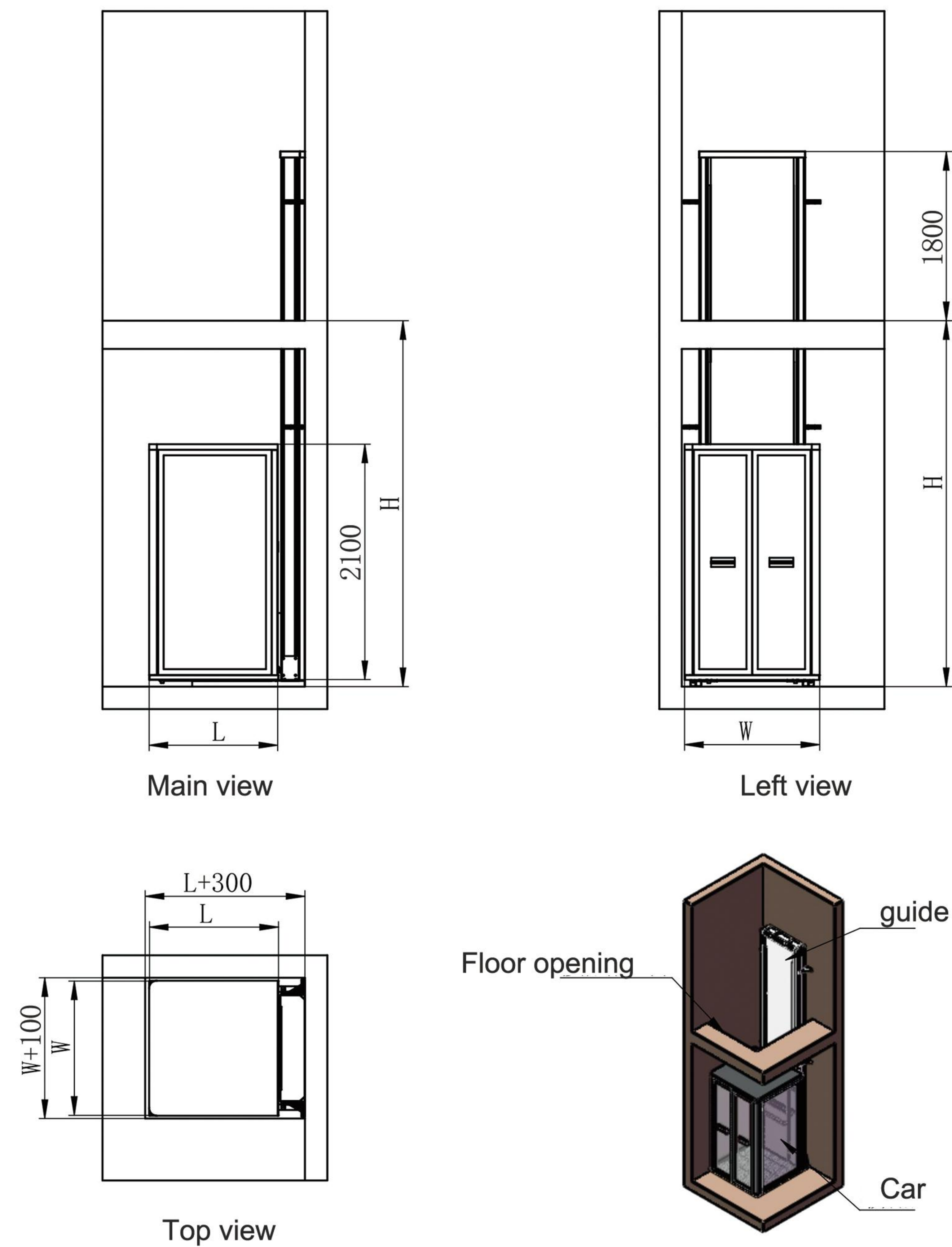

### Specification:

- 1.Cabin dimension:  $W*L$  mm
- 2.Traveling height:  $H$  mm
- 3.Equipment height:  $H+=1800$  mm
- 4.Installation space:  $(W+100)*(L+300)$ mm
- 5.Floor hole size:  $(W+100)*(L+300)$ mm

## Glass shaft plan

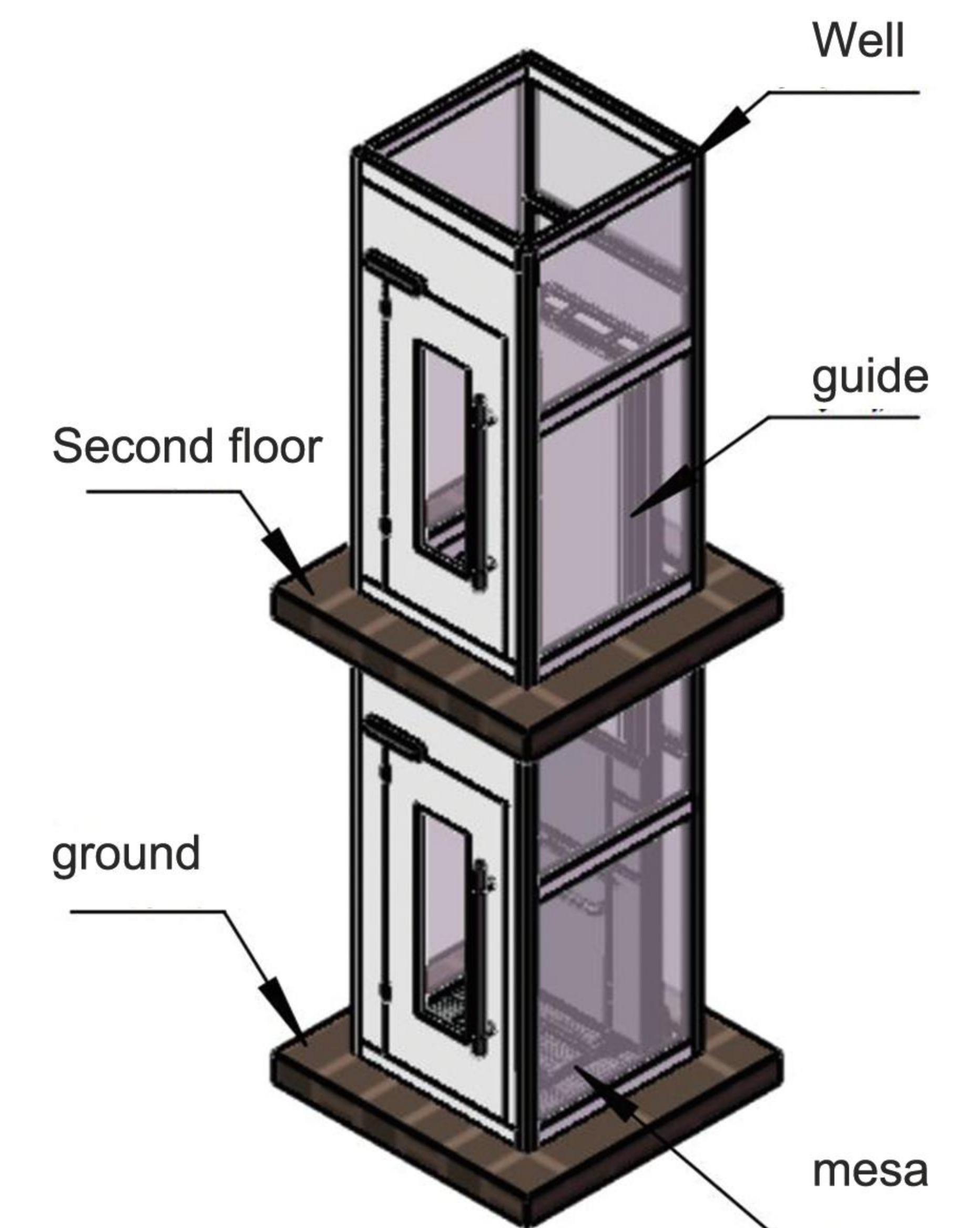
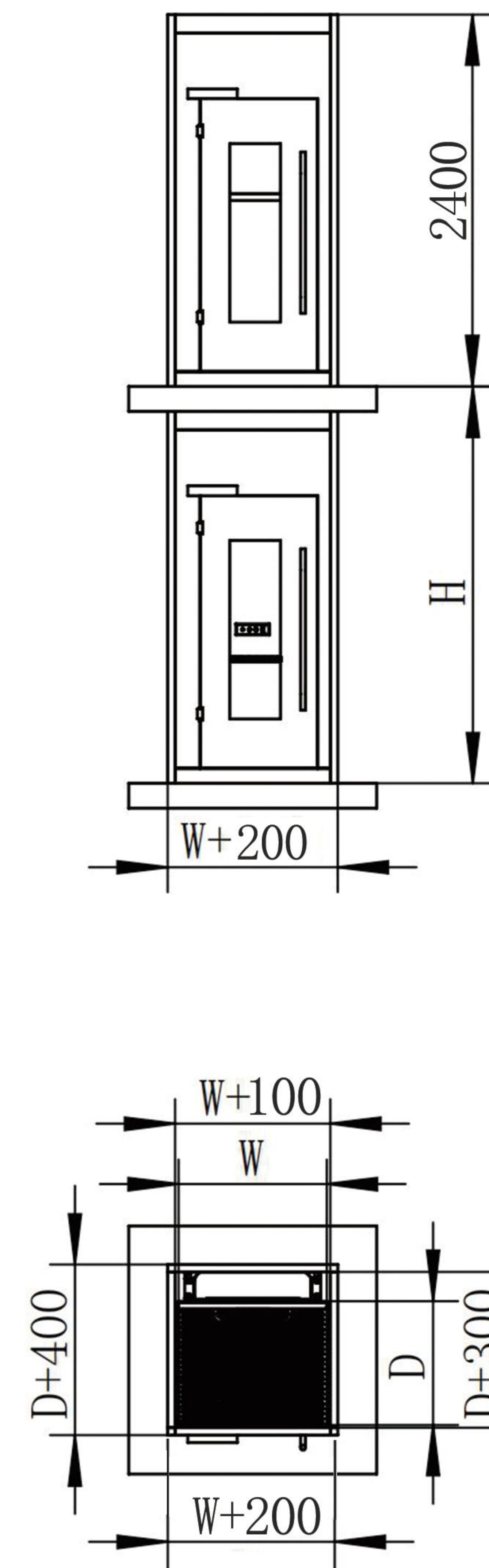

### Specification:

- 1.Platform size:  $W*D$  mm
- 2.Floor hole size:  $(W+100)*(D+300)$  mm
- 3.Glass shaft size:  $(W+200)*(D+400)$  mm
- 4.Traveling height:  $H$  mm
- 5.Shaft height:  $H+2400$  mm



# MRL Traction Villa Elevator

Traction drive, sensitive, convenient, smooth, comfortable, energy saving and environmental protection. MRL structure save space, which can meet different villa structures.

## Features:

- ◎ MRL (Machine Room Less): save construction costs
- ◎ VVVF drive technology: microcomputer control, stable and comfortable
- ◎ Special traction machine frame: fixed on the guide rail, the building can not bear the force
- ◎ Automatic dedicated door machine: frequency conversion energy saving, safe and reliable
- ◎ UPS (backup power supply) can save people in an emergency





# Car Decoration



## Standard

Ceiling: mirror stainless steel frame,  
LED light  
Car wall: Hairline stainless steel,  
mirror etching  
Floor: PVC

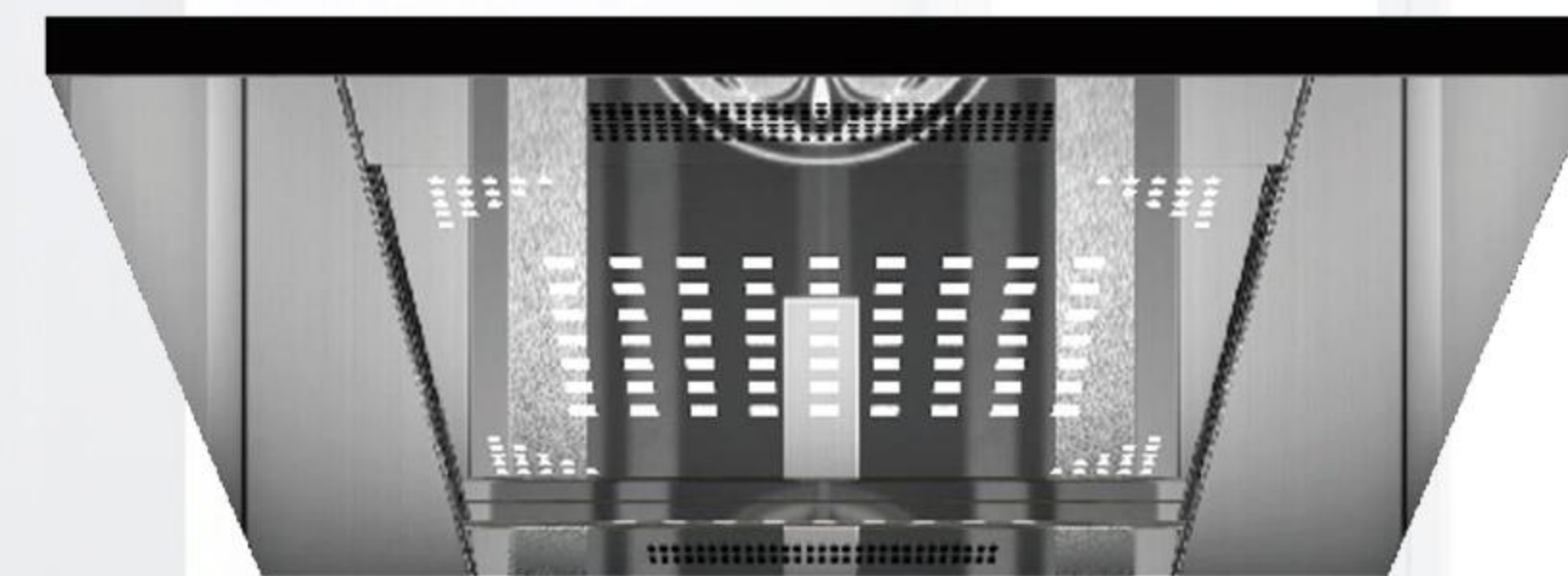

Ceiling:  
Mirror stainless steel frame, LED light



Floor: PVC

Ceiling: mirror stainless steel frame,  
LED light

Side wall: Hairline stainless steel

Rear wall: mirror stainless steel +  
pattern stainless steel

Floor: PVC

Ceiling: Hairline stainless steel,  
acrylic arched ceiling,  
downlight

Car wall: mirror, hairline, etching

Handrail: Hairline stainless steel flat handle

Floor: PVC







Ceiling: Titanium mirror stainless steel  
frame, acrylic ceiling,  
downlight

Side wall: Titanium mirror stainless steel

Rear wall: Titanium mirror etched  
stainless steel

Floor: PVC



Ceiling: Titanium mirror stainless steel,  
acrylic decoration, LED light

Car wall: titanium gold mirror stainless steel,  
titanium gold stainless steel

Floor: PVC



Ceiling: mirror stainless steel, cross-flow fan, LED white light  
 Car wall: left wall- wood grain steel, right and rear- sightseeing glass  
 Handrail: mirror stainless steel round handrail  
 Floor: PVC

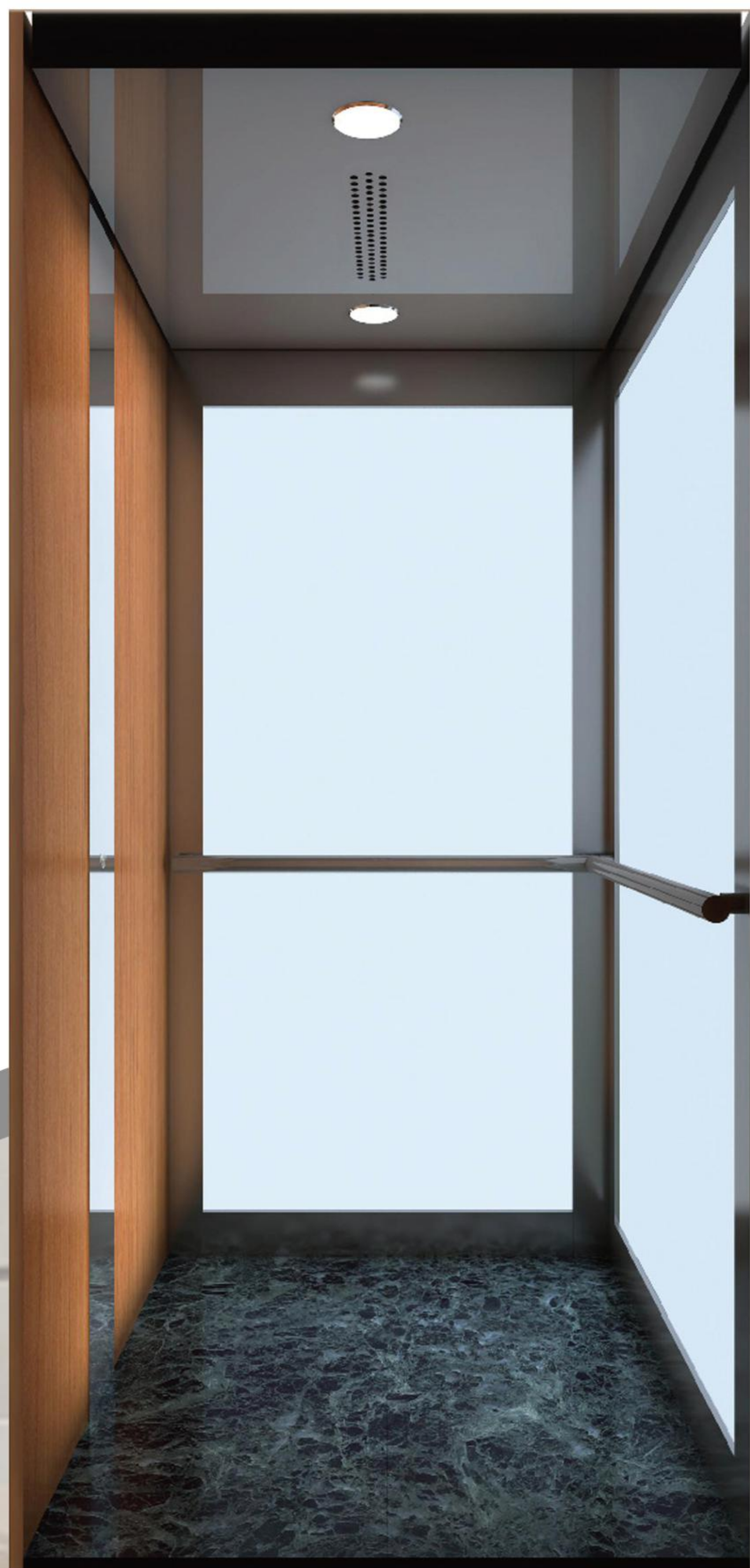

Ceiling: Hairline stainless steel, acrylic board, LED lighting  
 Car wall: Hairline stainless steel frame, transparent glass car wall  
 Handrail: Stainless steel single tube handrail  
 Floor: PVC

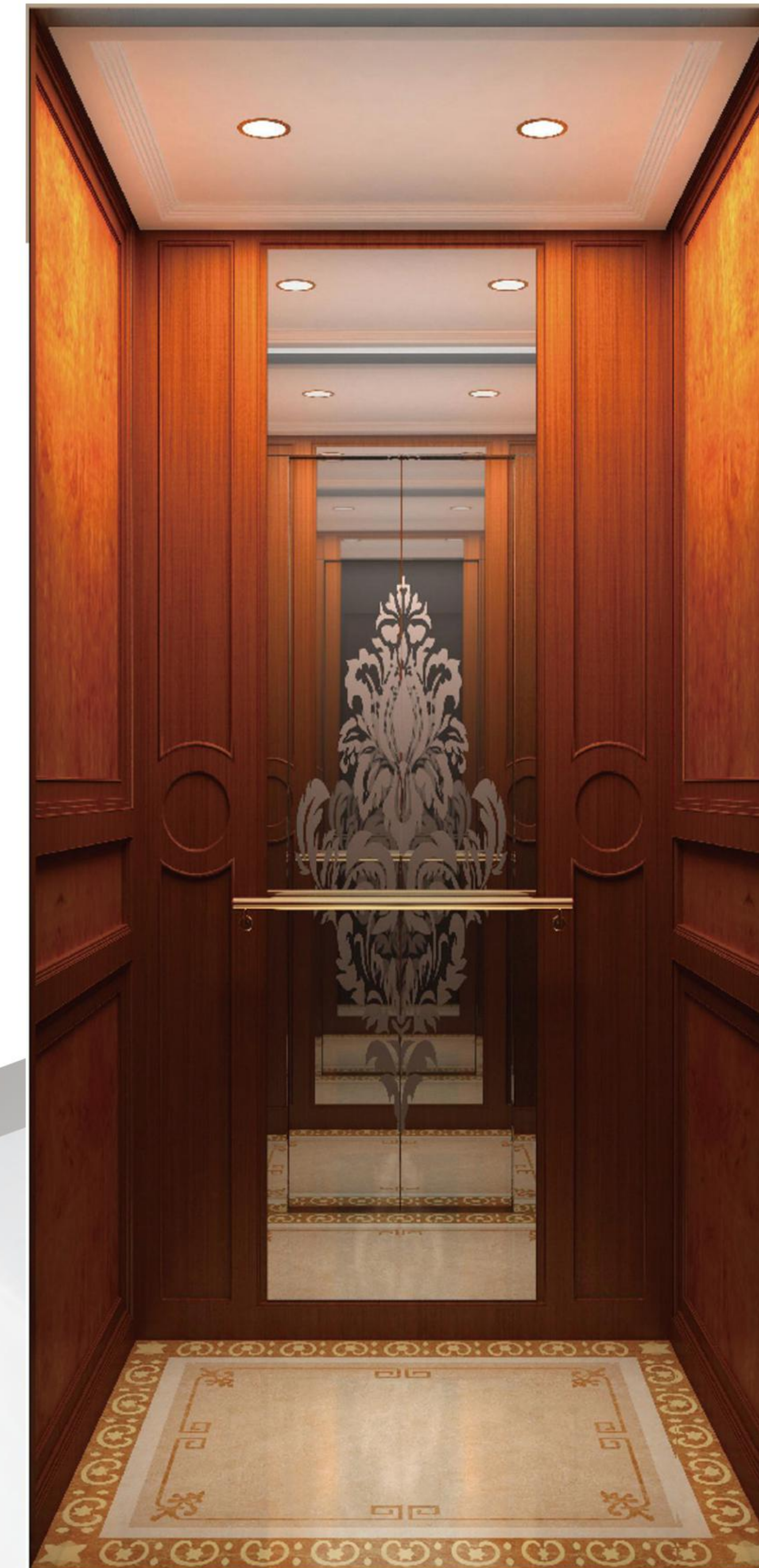

Ceiling: wood veneer, downlight  
 Car wall: wood veneer, solid wood lines, mirror stainless steel etching  
 Handrail: Titanium gold stainless steel  
 Floor: PVC



Ceiling: mirror stainless steel, acrylic board, LED lamp  
 Car wall: Mirror stainless steel, wood grain finish  
 Floor: PVC



# Decoration Configuration

## Control box series

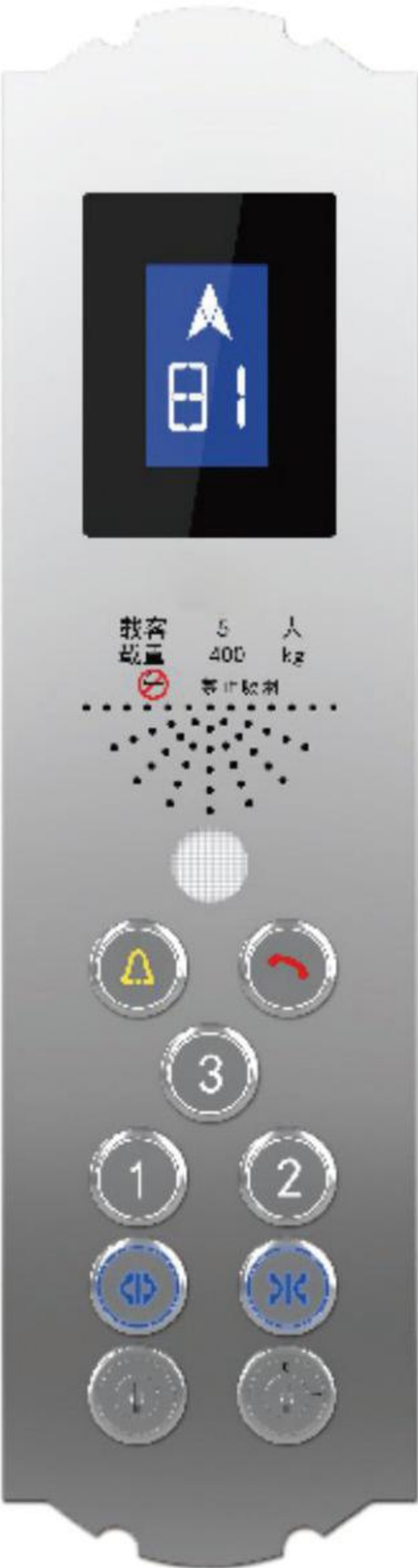

BALI-COP01



BALI-COP02



BALI-COP03



BALI-ZOP01



BALI-ZOP02



BALI-ZOP03

## Armrest series



BALI-F001



BALI-F002



BALI-F003



BALI-F004

## Landing door series



BALI-T001  
Hairline stainless steel



BALI-T002  
Mirror, etching

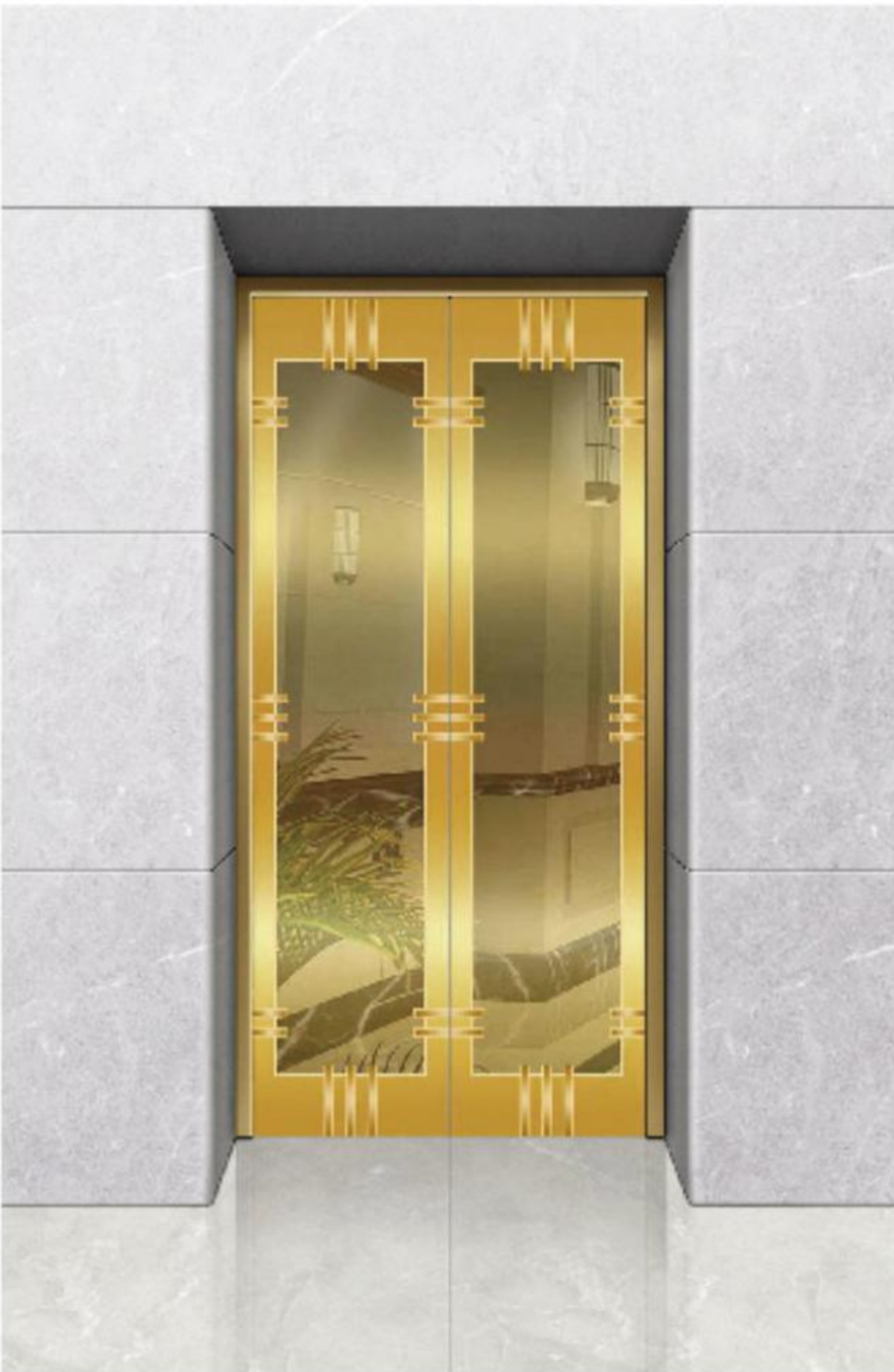

BALI-T003  
Titanium, sightseeing glass



BALI-T004  
Titanium, etching



# Decoration Configuration

## Ceiling series

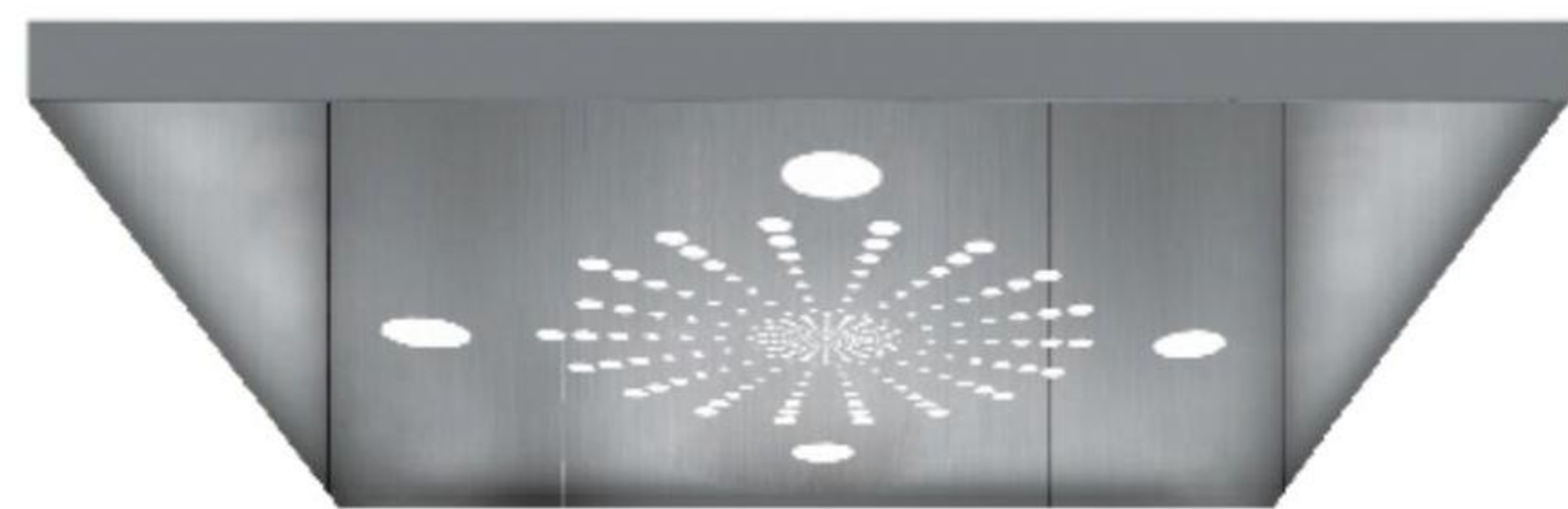

BALI-D001  
Hairline stainless steel frame, LED light



BALI-D002  
Mirror stainless steel frame, downlights around, LED lights in the middle

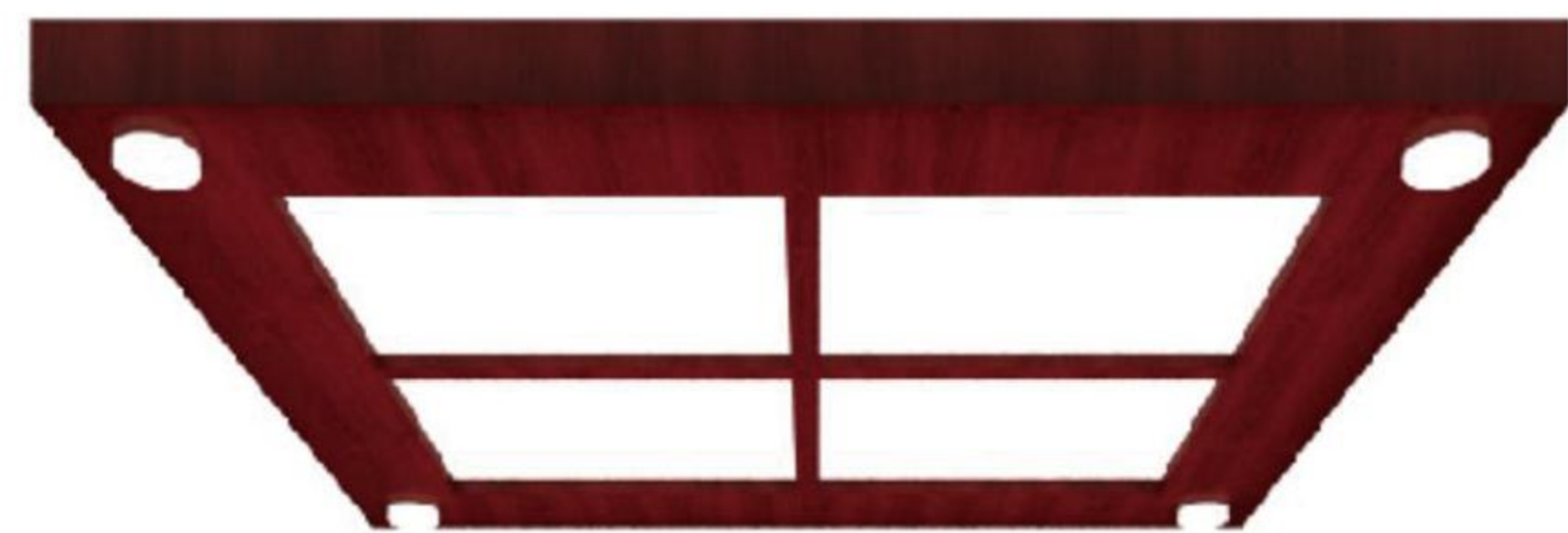

BALI-D003  
Wood grain frame, surrounding downlight, middle LED light



BALI-D004  
Mirror stainless steel frame, black titanium mirror stainless steel, downlight

## Floor series



BALI-B001

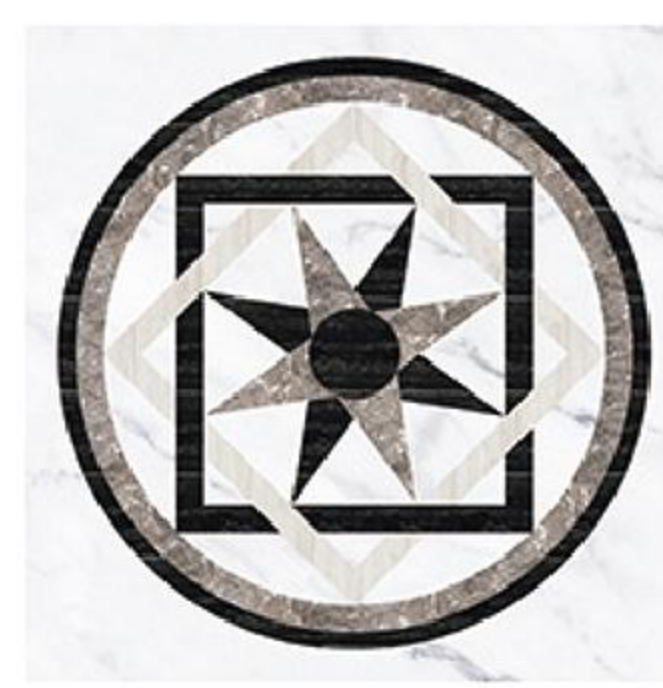

BALI-B002

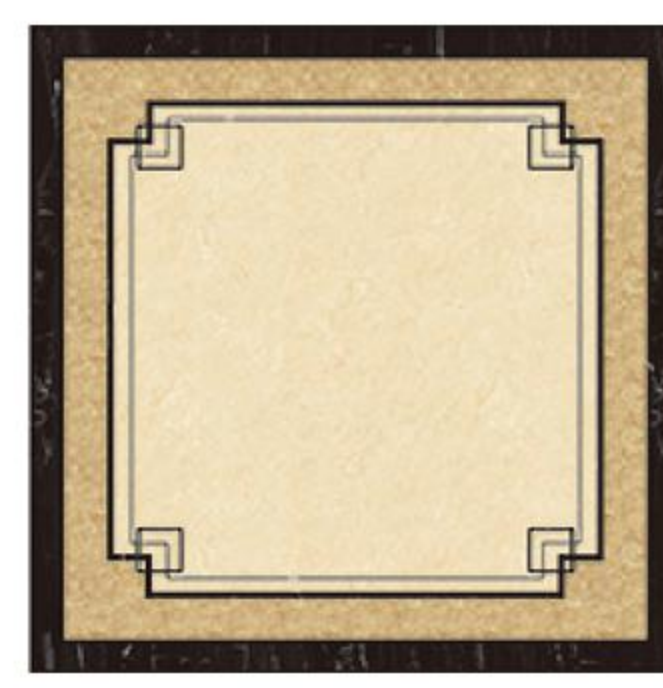

BALI-B003

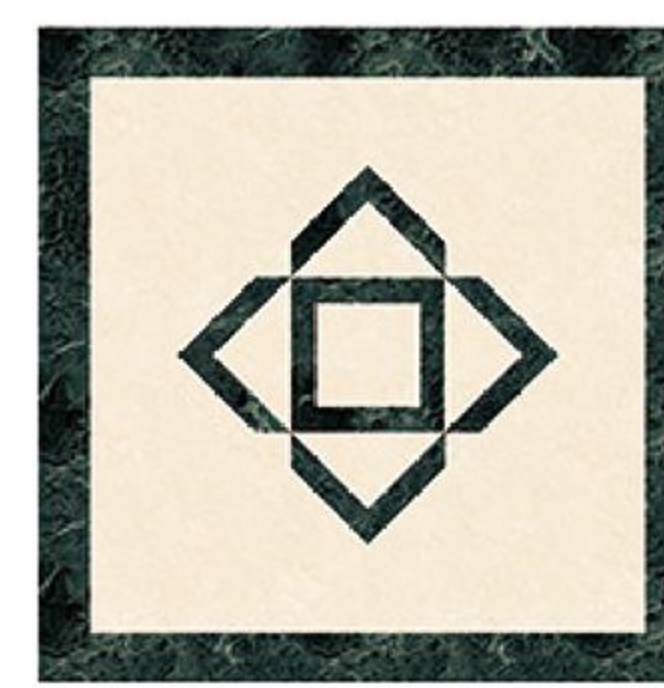

BALI-B004



BALI-B005

# Steel belt civil engineering drawing (counterweight at side)

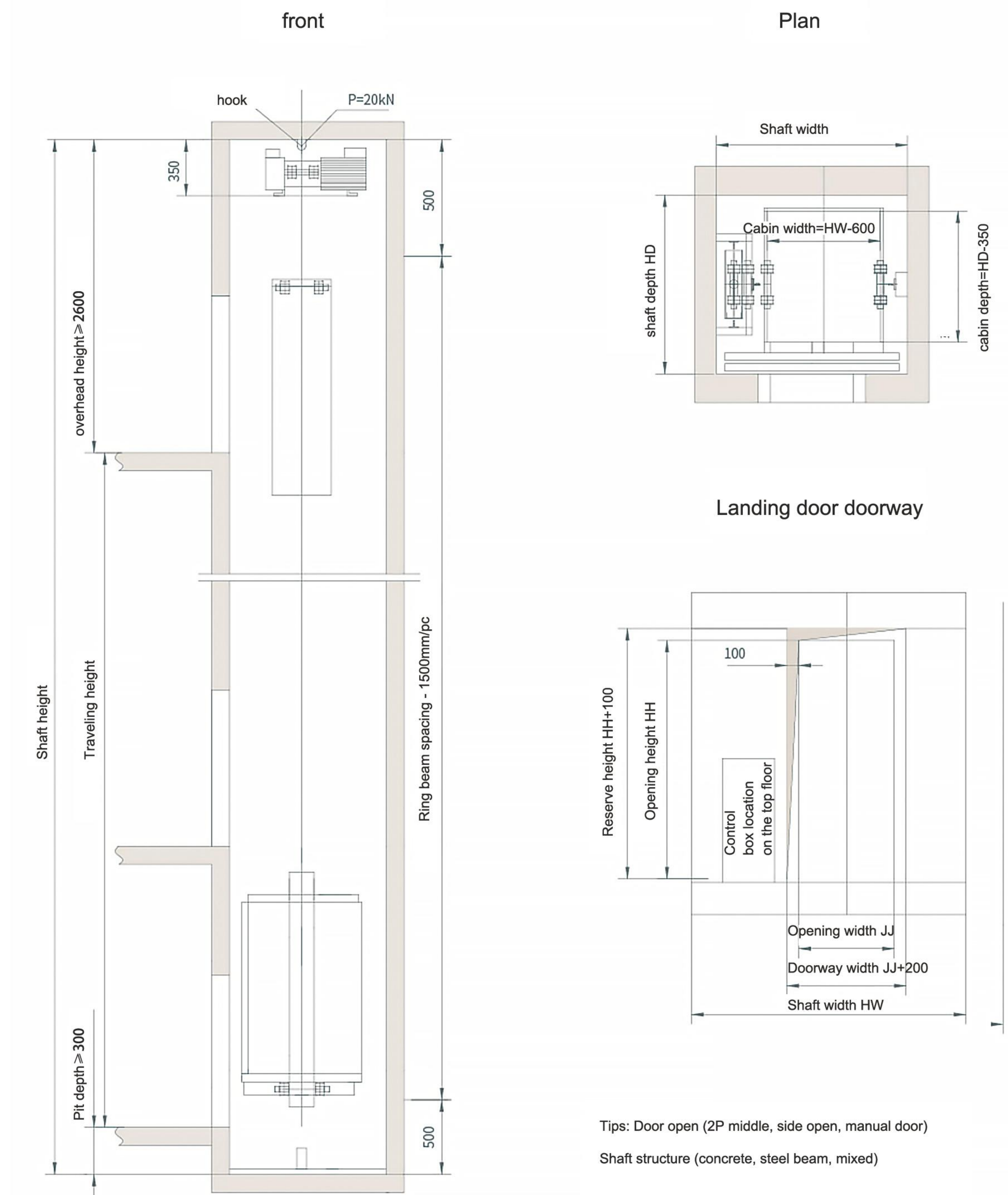



# Steel rope civil engineering drawing (counterweight at back)

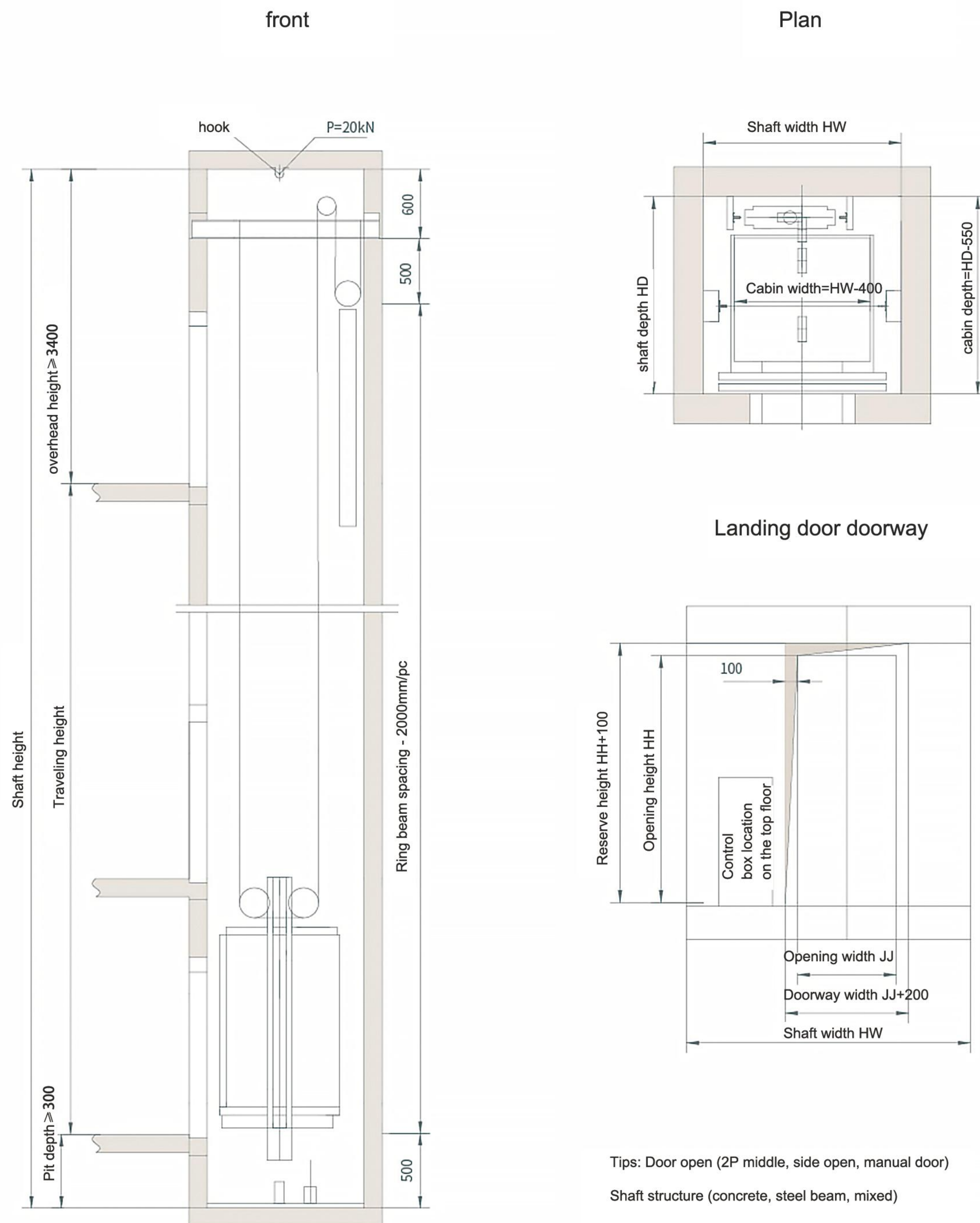

# 90° cabin civil engineering drawing

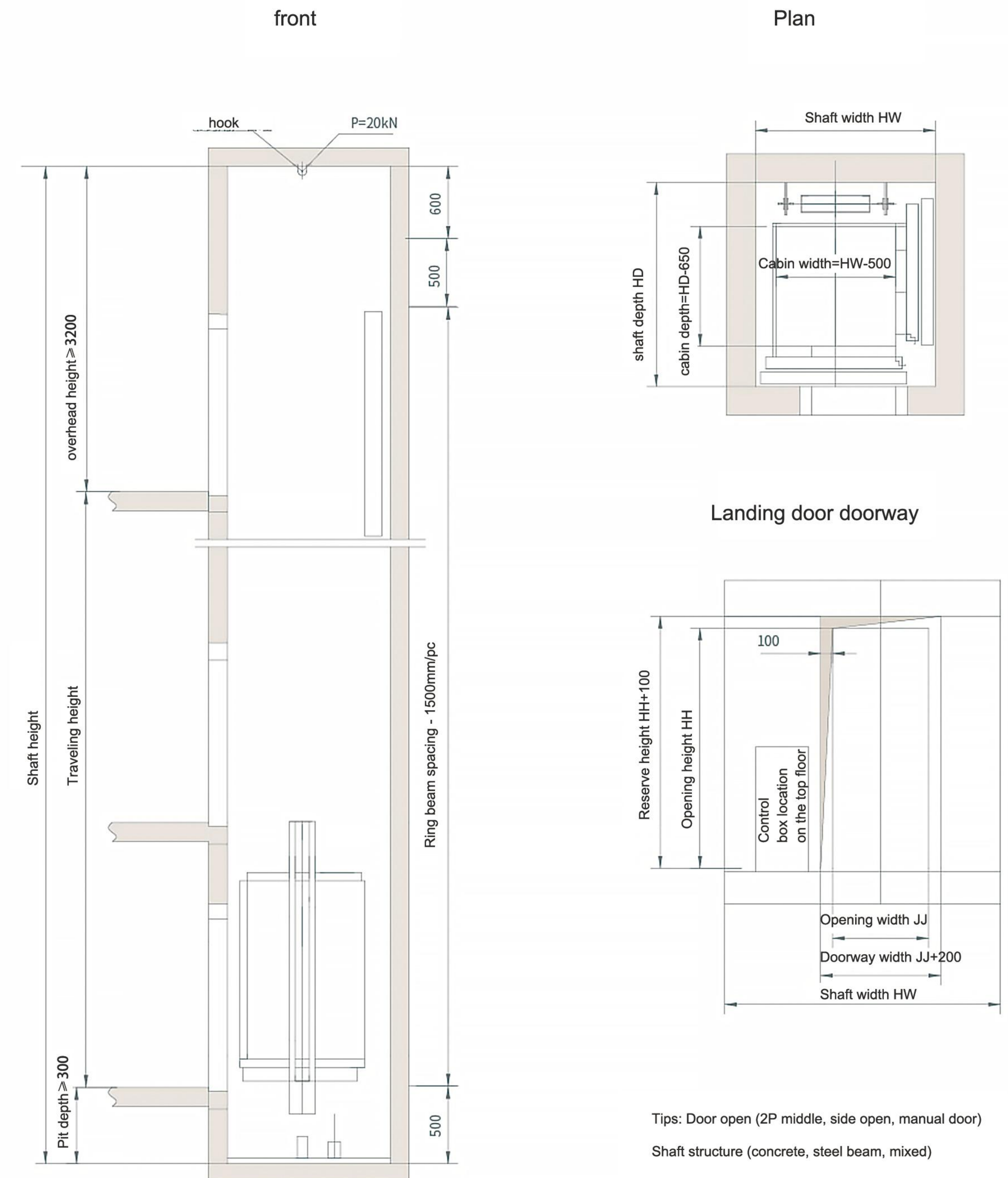





## Whole-hearted service

### Personalized service

If you choose us, you will get the one-stop service. Demand analysis in advance, to the mid-term civil construction survey, customer-made plan, installation training and commission to the later maintenance services. Whole process of professional standardization service is provided.

We will offer drawing based on your measurement. Start the personalized customization service of the home elevator.

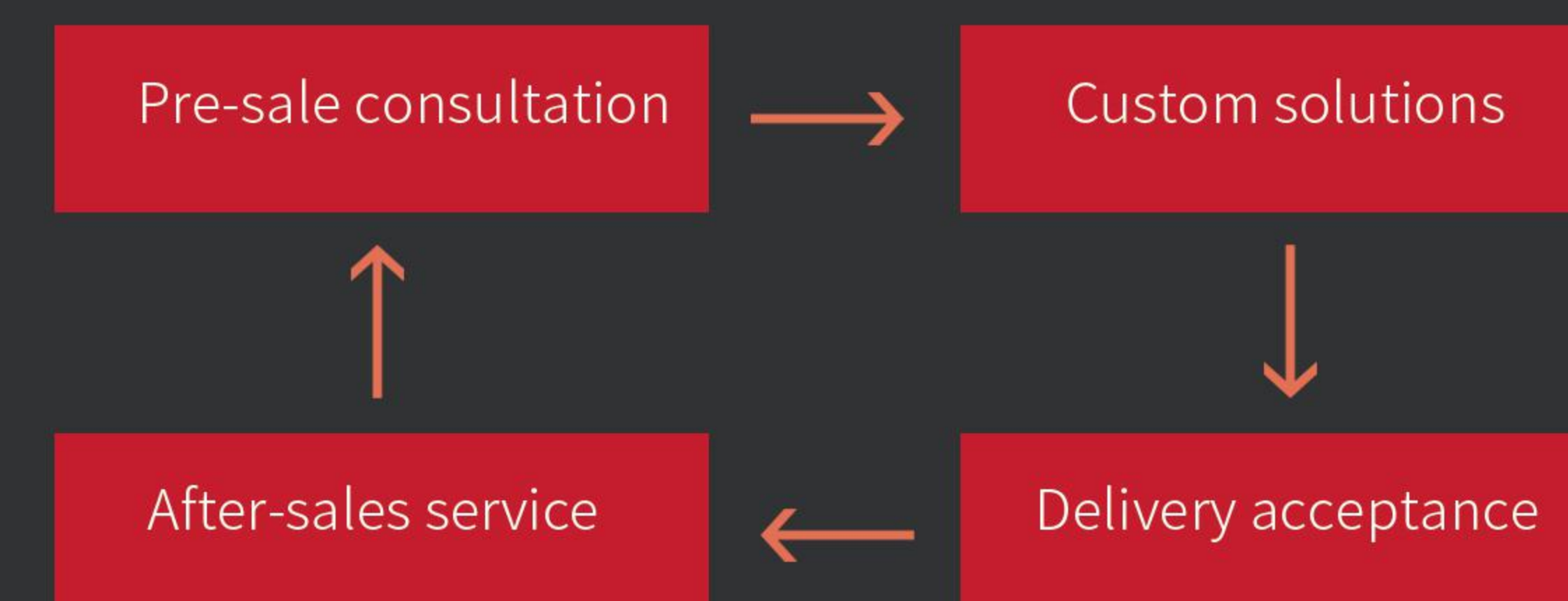

professional team



Service Hotline



Express service



Professional maintenance